

NOTE:

IN THE EVENT PROPOSED DRIVE
IS COMPLETED PRIOR TO CONC.
SIDEWALK PAVING, PLACE 3-18"
#3 BARS 9" OUT PAVEMENT
FOR SIDEWALK CONNECTION.

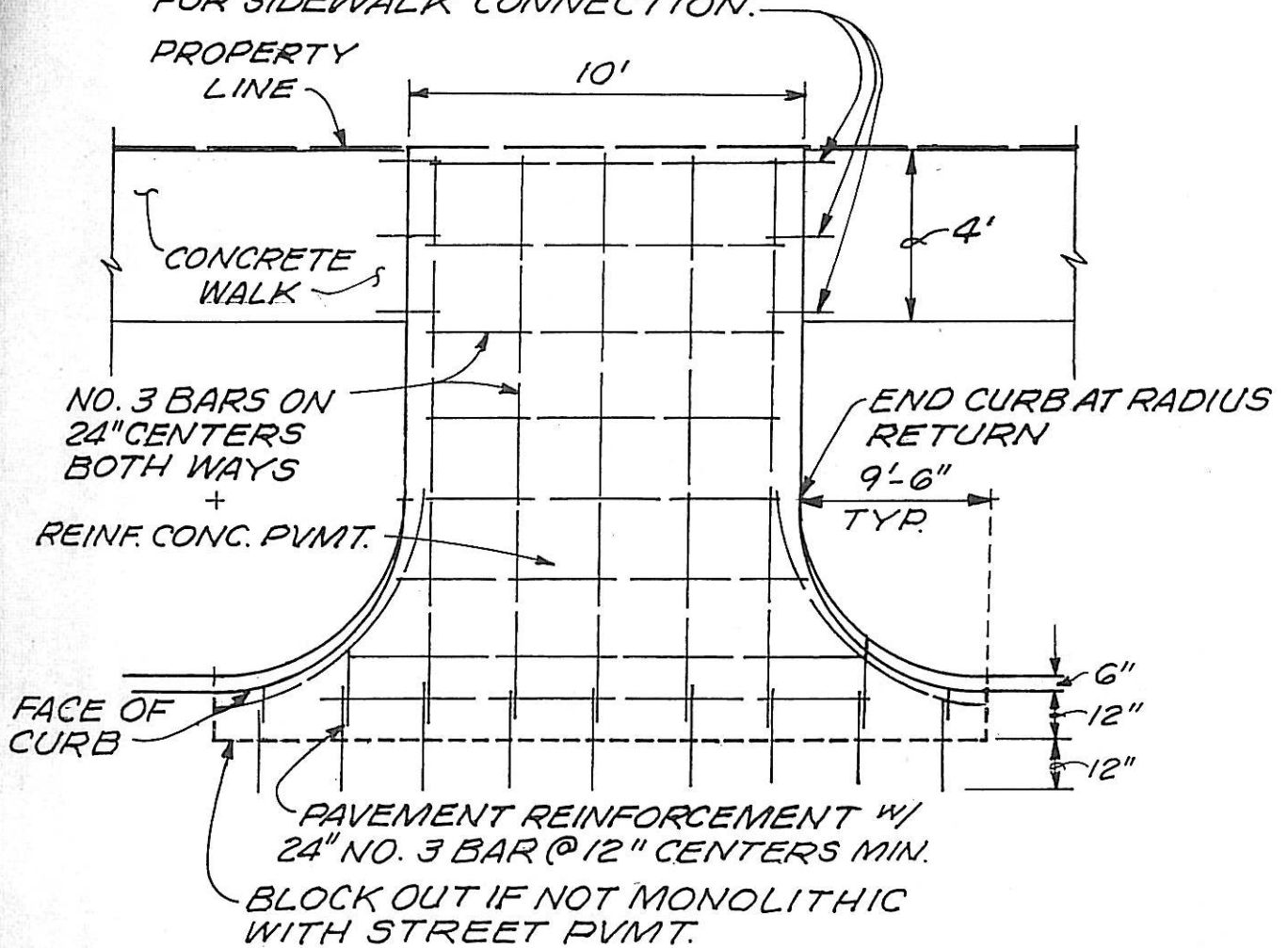

DRIVEWAY PAVING DETAILS

N.T.S.